

CITY:
EDGEWATER, FL

LOCATION:
AIRPARK RD

COUNTY:
VOLUSIA

JOB DURATION:
11 DAYS

SCOPE OF WORK:
INSTALLING UTILITIES

SUMMARY

HAZEN CONSTRUCTION WILL BE WORKING ON SEVERAL LOCATIONS INSTALLING STORM CROSSING, WATER MAIN CROSSINGS, SEWER CROSSING WITH STRUCTURE AT THE CENTER OF THE ROAD(OAK TRAIL). JOB DURATION WILL BE 11 DAYS. WORK HOURS:9:00AM-3:00PM.

ROAD CLOSURE
AIRPARK RD
EDGEWATER, FL

DETOUR	
PREPARED FOR:	HAZEN CONSTRUCTION
DATE:	2-16-23
SCALE:	NONE
SHEET #:	1 of 3
DRAWN BY:	M. Sladewski - Better Barricades, Inc
CERT. #:	53815

A MESSAGE 7 DAYS BEFORE START:

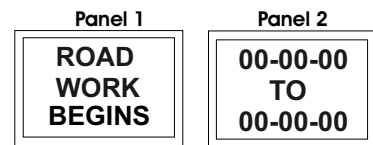

DURING WORK:

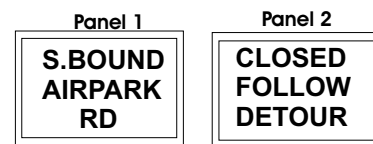

EXISTING ROAD WORK AHEAD SIGNS ON NORTH AIRPARK RD.

EXISTING ROAD WORK AHEAD SIGNS ON SR 442

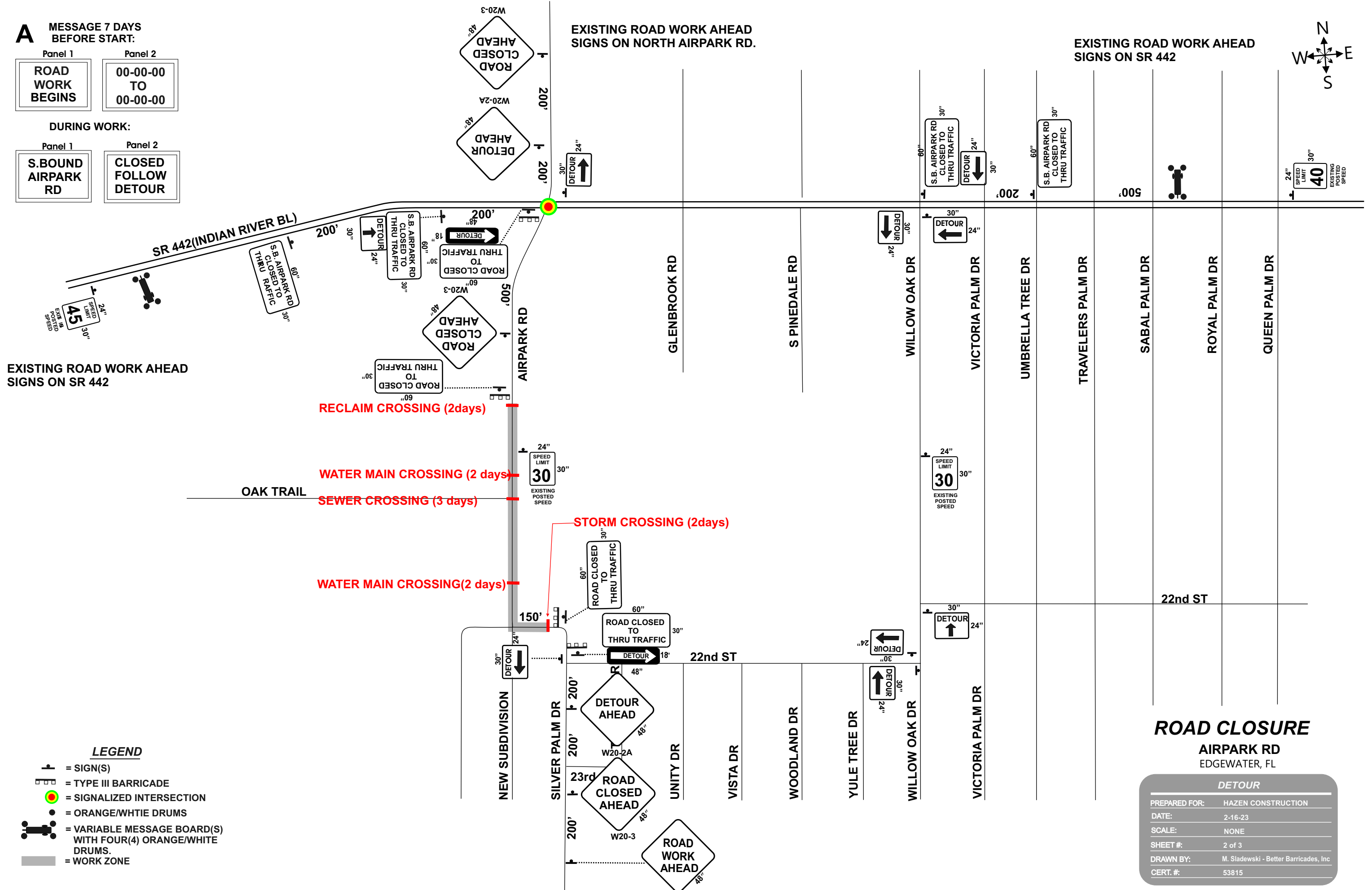

LEGEND

- = SIGN(S)
- = TYPE III BARRICADE
- = SIGNALIZED INTERSECTION
- = ORANGE/WHITE DRUMS
- = VARIABLE MESSAGE BOARD(S) WITH FOUR(4) ORANGE/WHITE DRUMS.
- = WORK ZONE

ROAD CLOSURE
AIRPARK RD
EDGEWATER, FL

DETOUR	
PREPARED FOR:	HAZEN CONSTRUCTION
DATE:	2-16-23
SCALE:	NONE
SHEET #:	2 of 3
DRAWN BY:	M. Sladewski - Better Barricades, Inc
CERT. #:	53815

NOTES

1. ALL SIGNS AND BARRICADES SHALL BE FABRICATED AND INSTALLED IN ACCORDANCE WITH THE MOST RECENT MANUAL ON UNIFORM TRAFFIC CONTROL DEVICES.
2. THE POSTED SPEED LIMIT THROUGH THE WORK ZONE SHALL BE SHOWN ON DRAWINGS.
3. ALL SIGNS SHALL BE INSTALLED FOR ADVANCE VIEWING (NO LIMBS OR OTHER OBJECTS BLOCKING VIEW).
4. CAUTION SHALL BE EXERCISED IN SIGN PLACEMENT AND TRAFFIC CONTROL DEVICES TO AVOID CAUSING SIGHT DISTANCE HAZARDS.
5. ALL SIGN SHALL BE POST MOUNTED UNLESS OTHERWISE NOTED AND ALL SIGNS 48" WIDE AND ABOVE SHALL BE MOUNTED ON TWO(2) POSTS.
6. WHEN REPLACING TEXT OR USING PLATES TO COVER TEXT ON SIGNS, ALL NEW TEXT ON THAT SIGN SHALL BE THE SAME SIZE AND THE MINIMUM STANDARD BEING THE EXISTING TEXT.
7. HIGHLIGHT FLAGS AT 45 DEGREE AS SHOWN.
8. ONLY IN EXTREME CASES WILL SIGNS BE MOUNTED ON TYPE III BARRICADES. ALL SIGNS MOUNTED ON TYPE III BARRICADES SHALL BE INSTALLED ABOVE THE THREE REFLECTIVE RAILS. THESE RAILS SHALL NOT BE BLOCKED.
9. CONTRACTOR WILL BE RESPONSIBLE FOR ADEQUATELY BARRICADING ALL AREAS DEEMED HAZARDOUS FOR VEHICULAR ACCESS INSIDE THE CONSTRUCTION ZONE.
10. CONTRACTOR SHALL PROVIDE PATHWAY PASSAGE WHEN WORK ZONE IS IN CONFLICT WITH PEDESTRIAN MOVEMENT PER THE MOST RECENT FDOT DESIGNS STANDARDS, INDEX 660.
11. LOCAL RESIDENTS AND EMERGENCY RESPONSE VEHICLES WILL BE PERMITTED ACCESS AT ALL TIMES.
12. WORK HOURS: 9:00AM - 3:00PM 11 DAYS
13. CONTRACTOR WILL BE RESPONSIBLE AND LIABLE FOR MAINTAINING DAY TO DAY PLACEMENT OF ALL TRAFFIC CONTROL DEVICES AND ALSO COVERING THE SIGNS EVERY DAY.
14. FLAGGER WILL BE AT EACH LOCATION(PHASE) TO HELP RESIDENCE AND EMERGENCY VEHICLES ACCESS THEIR PROPERTIES.

M.O.T. ON SITE REFERENCE MATERIAL:

Contractor shall maintain at the projects location (cell phone viewing not acceptable):
(1) 11"x17" paper copy of the approved MOT/Traffic Control Plan or FDOT Design Standards Index Sheet.
(2) 8"x11" print of the sent formal email approval, if applicable.

ROAD CLOSURE

AIRPARK RD
EDGEWATER, FL

DETOUR

PREPARED FOR:	HAZEN CONSTRUCTION
DATE:	2-16-23
SCALE:	NONE
SHEET #:	3 of 3
DRAWN BY:	M. Sladewski - Better Barricades, Inc
CERT. #:	53815